



Graphics Pen Display

PD1610

Windows 7 or later, macOS 10.12 or later, Android(USB3.0 DP1.2)

Precautions

1. Please read this manual carefully before using, and keep it well for future reference.
2. Before cleaning the pen display please unplug the power cord and wipe with a soft damp cloth, do not use any kind of detergents.
3. Don't expose this product to water or other liquids. Take care to never spill liquids onto the pen display, digital pen, power cable, or power adapter.
4. Don't place the pen display or digital pen on where is unstable or a height.
5. Don't place the tablet on where children reaching easily in order to avoid danger.
6. Don't place the display and digital pen close to the magnetic field.
7. Only power supplies shown on the nameplate can be used for the display. If you have questions about the power supply which you are using, please consult the distributor of your display.
8. To protect your display, please switch off the power when it is not in use. During blackouts or not using for long time, please unplug the display from the socket.
9. Don't overload the socket or lengthen the power wire, which may lead to electric shocks.
10. Make sure no foreign bodies get inside the monitor through grooves and prevent liquid from splashing on the display as to prevent short-circuit or fire.
11. If the display has a breakdown, do not open the main case and try to repair it by yourself. Please ask for a service for proper repair and maintenance.
12. When the following situations occur, please unplug the power adapter and you may need a service for full repair and maintenance:
 - A. The power wire or plug is damaged or worn out;
 - B. There is liquid splashed inside of the display;
 - C. The display has fallen or the LCD is broken;
 - D. When obvious abnormalities occur to the display.
13. While getting the components replaced, you are supposed to guarantee that the repairman is using the substitute components specified by the manufacturer. Unauthorized component replacement might cause fire, electric shocks or other dangers.

Content

1. Product Overview.....	4
1.1 Product Introduction.....	4
1.2 Product and Accessories.....	4
1.3 Connection.....	6
1.4 Driver Installation.....	8
1.5 Pen Nib Replacement.....	9
2. OSD Settings.....	10
3. Function Settings.....	11
3.1 Device Connection Prompt.....	11
3.2 Working Area Setting.....	12
3.3 Pen Buttons Function Setting.....	15
3.4 Pressure Sensitivity Setting.....	16
3.5 Pen Pressure Testing.....	17
3.6 Calibration.....	18
3.7 Enable the Windows Ink Feature.....	19
3.8 Mouse Mode (Only for specific models).....	20
3.9 Customize Express Keys and Pressure Curve.....	21
3.10 Data Export and Import.....	22
4. Specifications.....	23
5. Trouble Shooting.....	24
5.1. Breakdowns Related to Display.....	24
5.2. Breakdowns Related to Functions.....	25
6. Contact Us for After-sales Service.....	25

1. Product Overview

1.1 Product Introduction

Thanks for buying GAOMON PD1610 Pen Display. This is a new generation of professional battery-free pen display, which can greatly improve your work efficiency of painting and creation, and full of fun. You can freely painting and writing, depicting different lines and colors, just as the pen writes on the paper, which brings you a real shock experience.

To give you a better understanding and using of your tablet, please read this user manual carefully. The user manual only shows the information under Windows, unless otherwise specified, this information applies to both Windows and Macintosh systems.

1.2 Product and Accessories

1.2.1 Pen Display

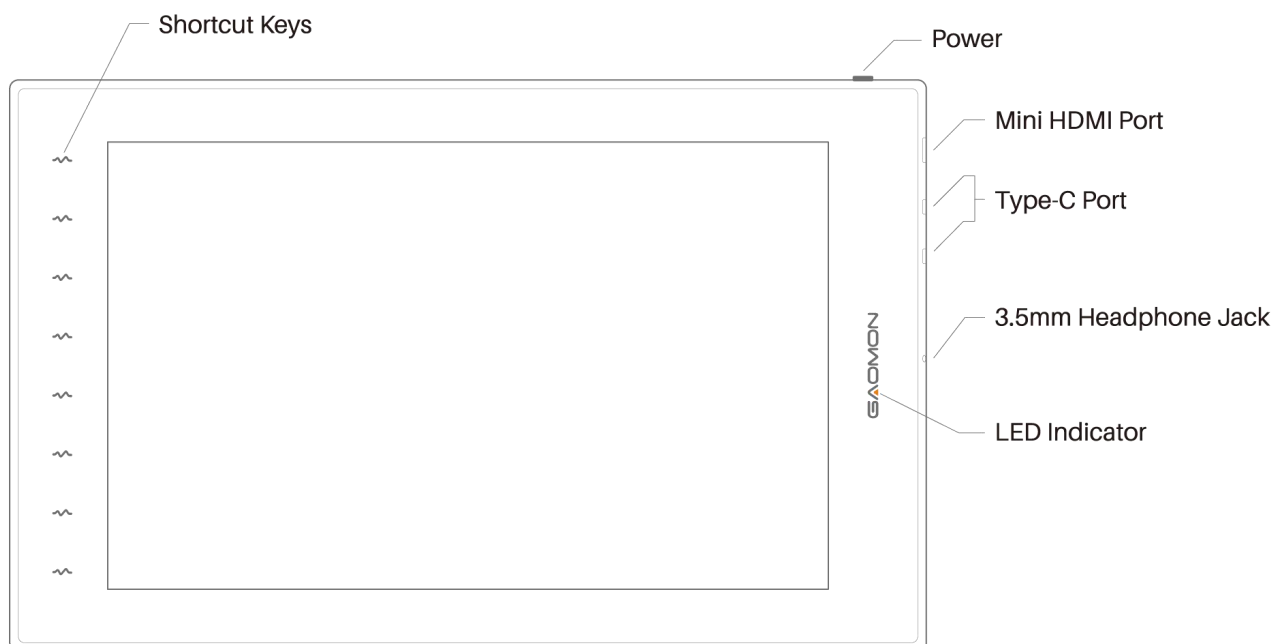

1.2.2 Digital Pen

The digital pen is battery-free and boasts 8192 levels of pressure sensitivity.

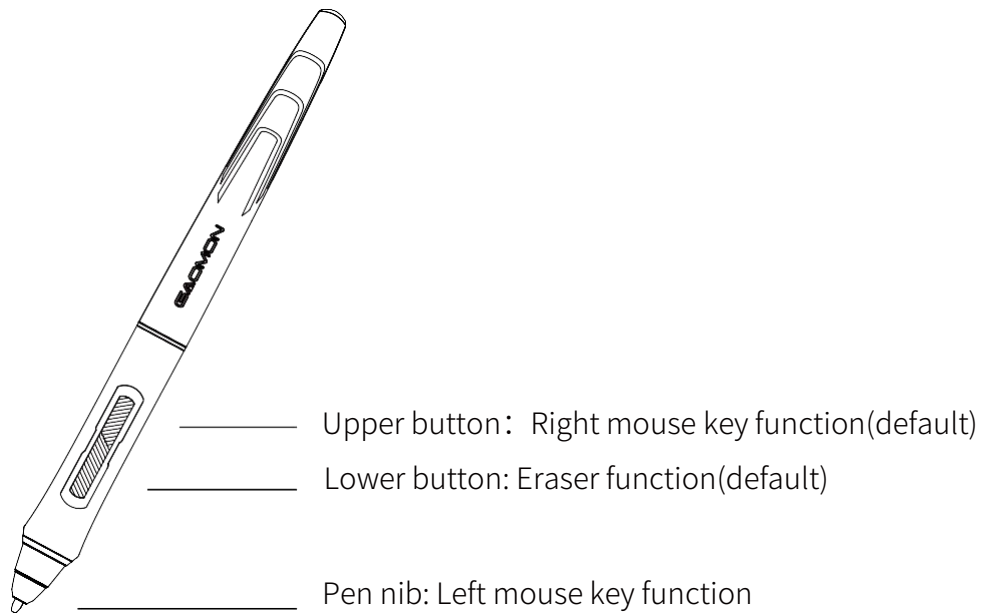

1.2.3 Accessories



Digital Pen



Pen Holder



Pen Nib Clip

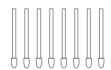

Replacement Nibs

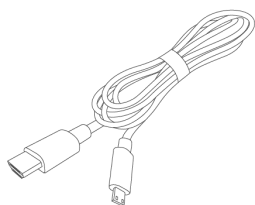

HDMI to Mini HDMI Cable

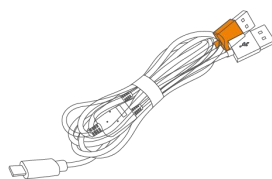

Type-C to Dual USB-A Cable

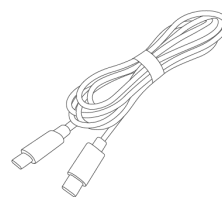

Type-C Cable

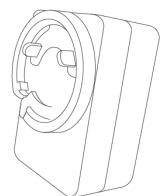

Power Adapter

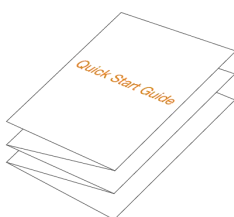

Quick Start Guide

1.3 Connection

Method 1: Connection with PC that has HDMI port

Step 1: Connect the pen display to PC with the HDMI cable;

Step 2: Connect the pen display to PC with the Type-C male plug inserted into the pen display, the black USB-A male plug inserted into the computer, and the red male plug inserted into the adapter.

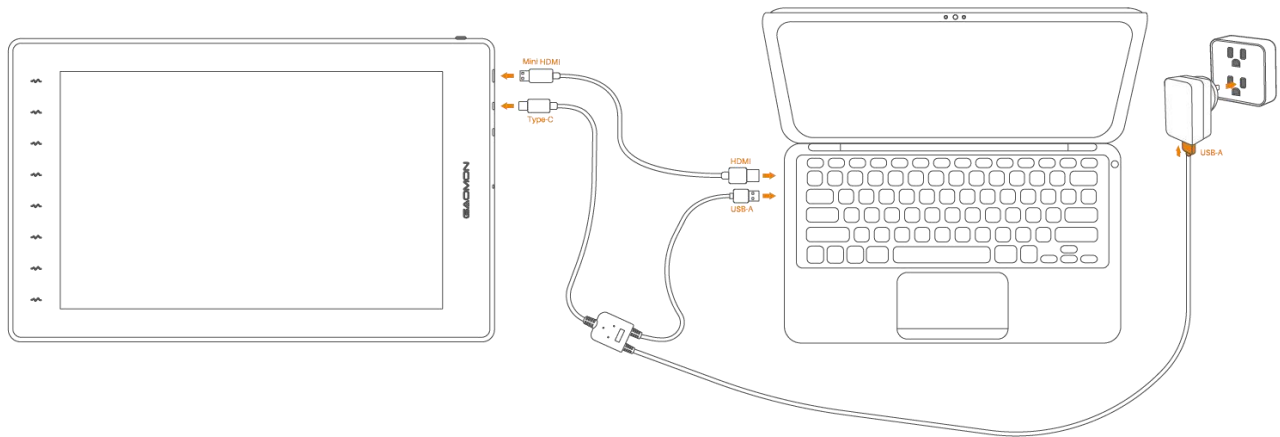

Method 2:

Step 1: Connect the pen display (both Type-C ports can do the work) to PC with the Type-C to Type-C cable.

For Your Attention: Please make sure the Type-C port on PC should support USB3.1 and DP1.2 protocols.

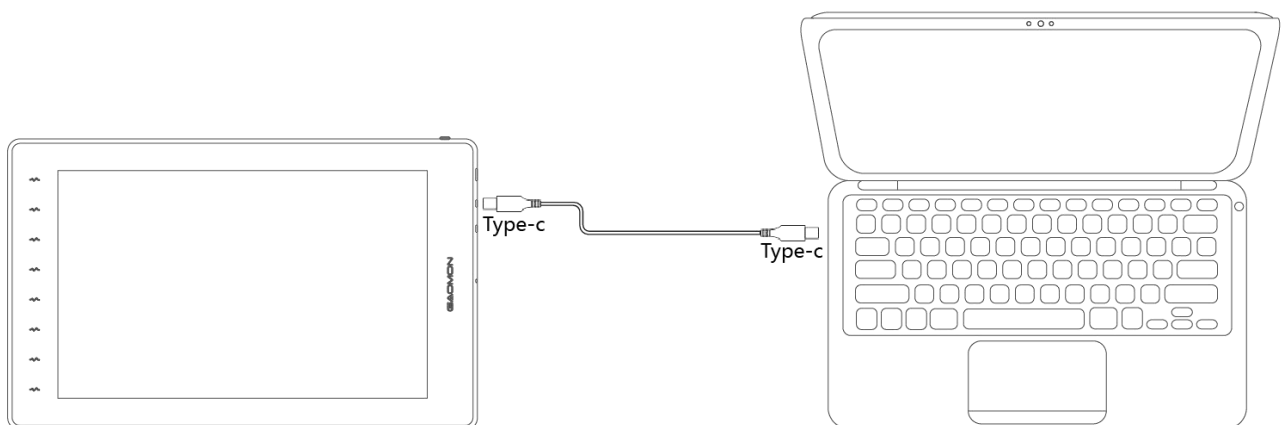

Step 2: A flashing screen may occur if the output power of PC is insufficient, in such case, you need to insert the red male plug of 2-in-1 cable into the adapter. And as shown below, please don't insert the USB-A plug to PC, otherwise USB Device Not Recognized error may occur.

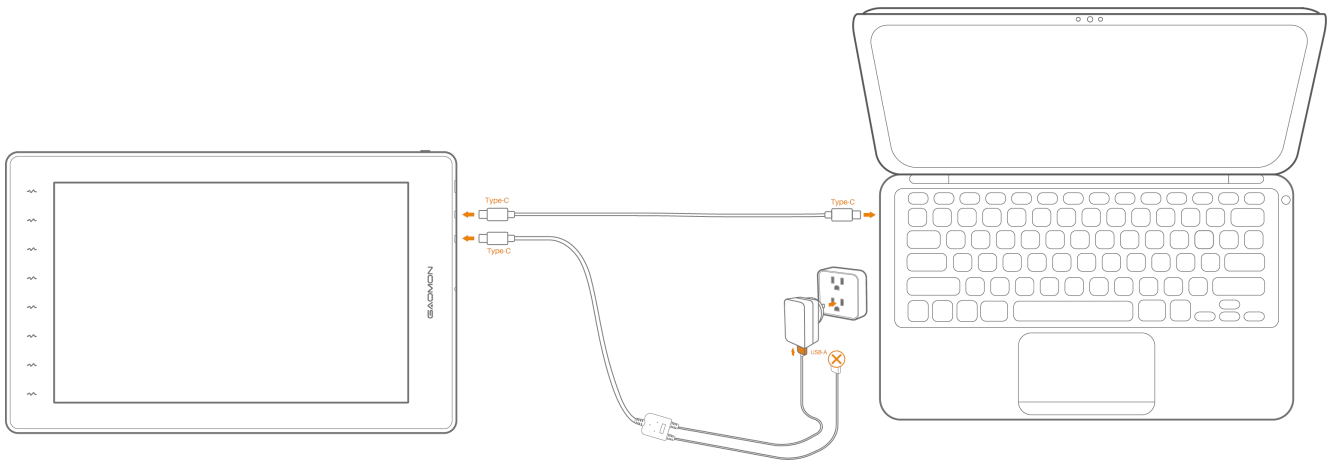

Method 3: Connection with Android phones that support TNT mode.

Step 1: Insert the 2-in-1 USB cable into pen display and adapter respectively.

Step 2: Connect the pen display to the Android phone with a type-C to type-C cable;

Note: Please make sure to connect the drawing monitor with power adapter to power it on **FIRSTLY**. Use the full functional Type-C cable to connect the phone in **LASTLY**. The order is very important. Otherwise the power indicator light will flash slowly and the monitor cannot display normally.

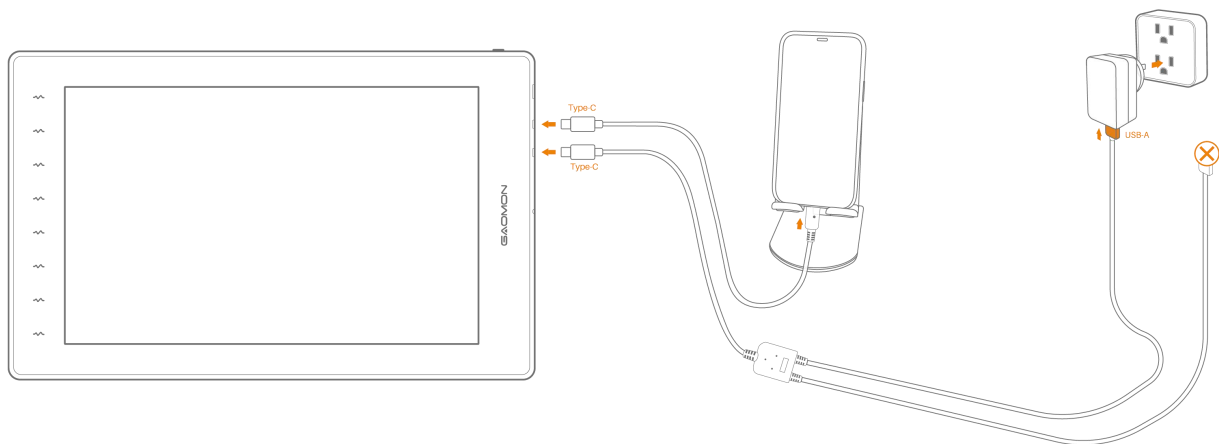

Note:

Please make sure your Android phone supports 'Dex', 'Desktop', or 'TNT' mode.

Visit GAOMON website for compatible phone models:

https://gaomon.net/Pen_Display/PD1610.html



1.4 Driver Installation

1.4.1 OS Support

Windows 7 or later, macOS 10.12 or later, Android(USB3.0 DP1.2)

1.4.2 Install Driver

Please download the driver from our website: www.gaomon.net/download

After finishing installation, you can find the grey driver icon  in the system tray area, which means the driver was installed successfully; when you connect the tablet to computer, the icon will become orange  , which means the driver has already recognized the tablet and you can start using it now.

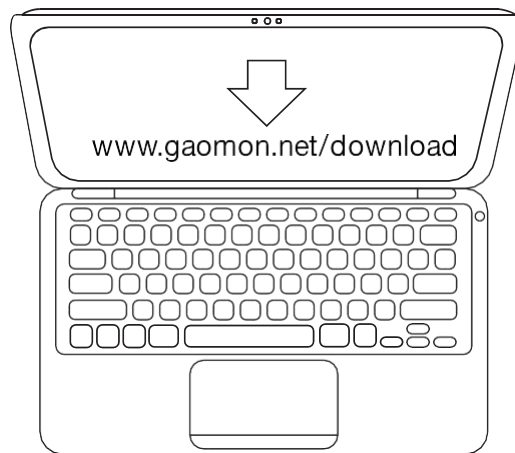

Note:

1. Before installing, you need to uninstall other driver of similar products, including the old driver of this product.
2. Before installing, please close all graphics software and anti-virus software to avoid unnecessary mistakes.

1.5 Pen Nib Replacement

1. The nib will wear off after using for a long time, then you need to replace a new nib.
2. Unscrew the pen holder and take out a new nib.
3. Insert the old pen nib into the hole at the bottom of the pen holder and tilt the pen to pull out the nib.
4. Insert a new pen nib into the stylus and push the nib until it stops.

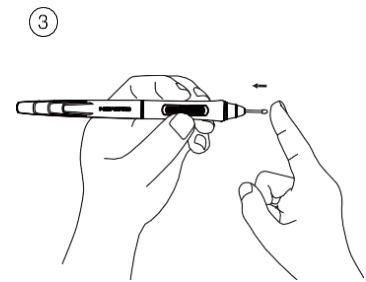
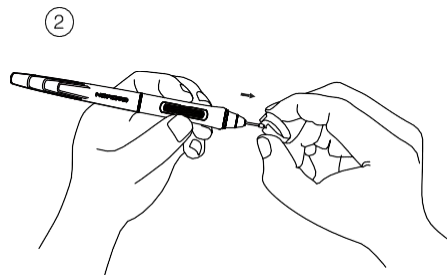
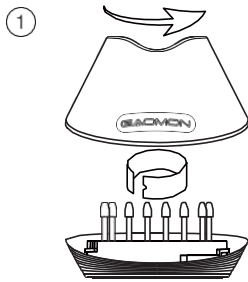

2. OSD Settings

Enter OSD menu:

Press ① for 3Sec to start OSD menu.

Press ① for 3Sec to exit OSD menu.

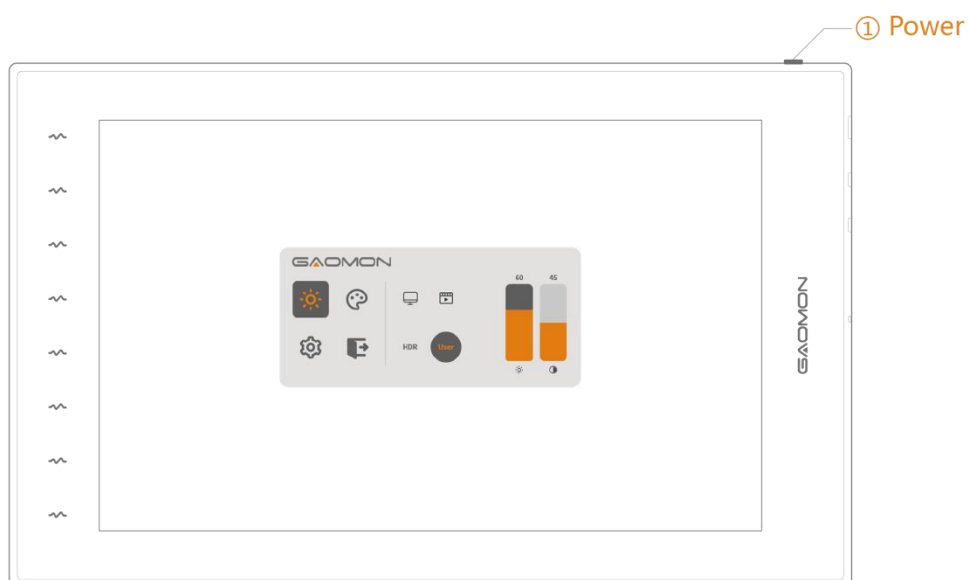

3. Function Settings

3.1 Device Connection Prompt

1. No Device Detected: The computer does not recognize the tablet.
2. Device connected: The computer has recognized the pen display.

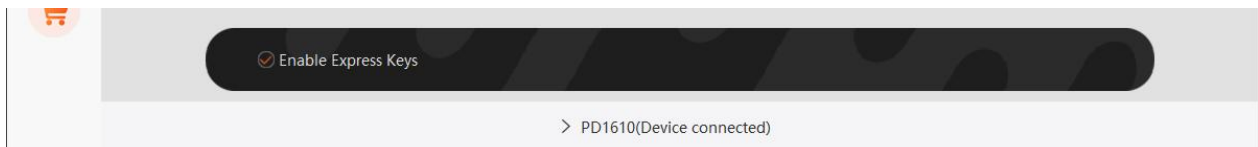
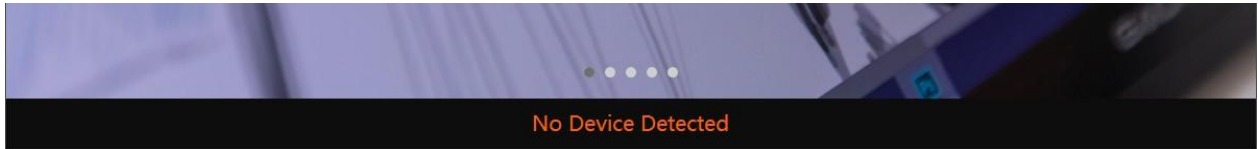

3.2 Working Area Setting

3.2.1 Using Multiple Monitors

The location of cursor depends on the screen mode you chose when connected the pen display to an external display (such as laptop or all-in-one PC), for instance:

In Duplicate Mode, the pen display and the external display will show the same picture, and the cursor will be displayed on each monitor simultaneously.

In Extend Mode, you need to choose the monitor on the driver interface to decide the cursor location.

When the location of the cursor is decided, you can map the working area on the driver interface.



3.2.2 Working Area Setting

Define the tablet area that will be mapped to the screen area.

1. Full Area: The entire active area of the tablet. This is the default setting.
2. Custom Area: Drag the corners of the foreground graphic to select the screen area.

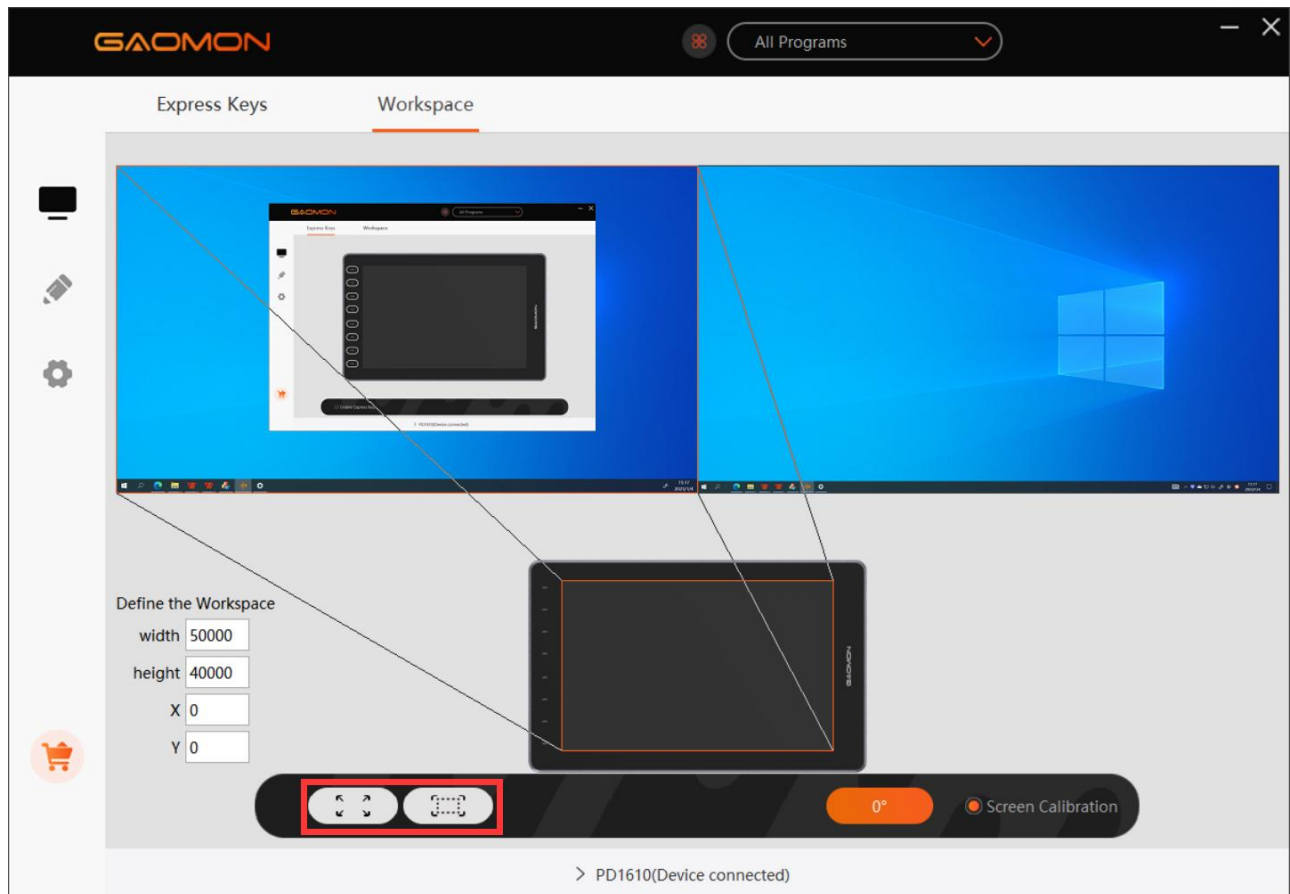

3.2.3 Rotate Working Area

By changing the direction of the pen display to provide more choices for users. Four directions are available.

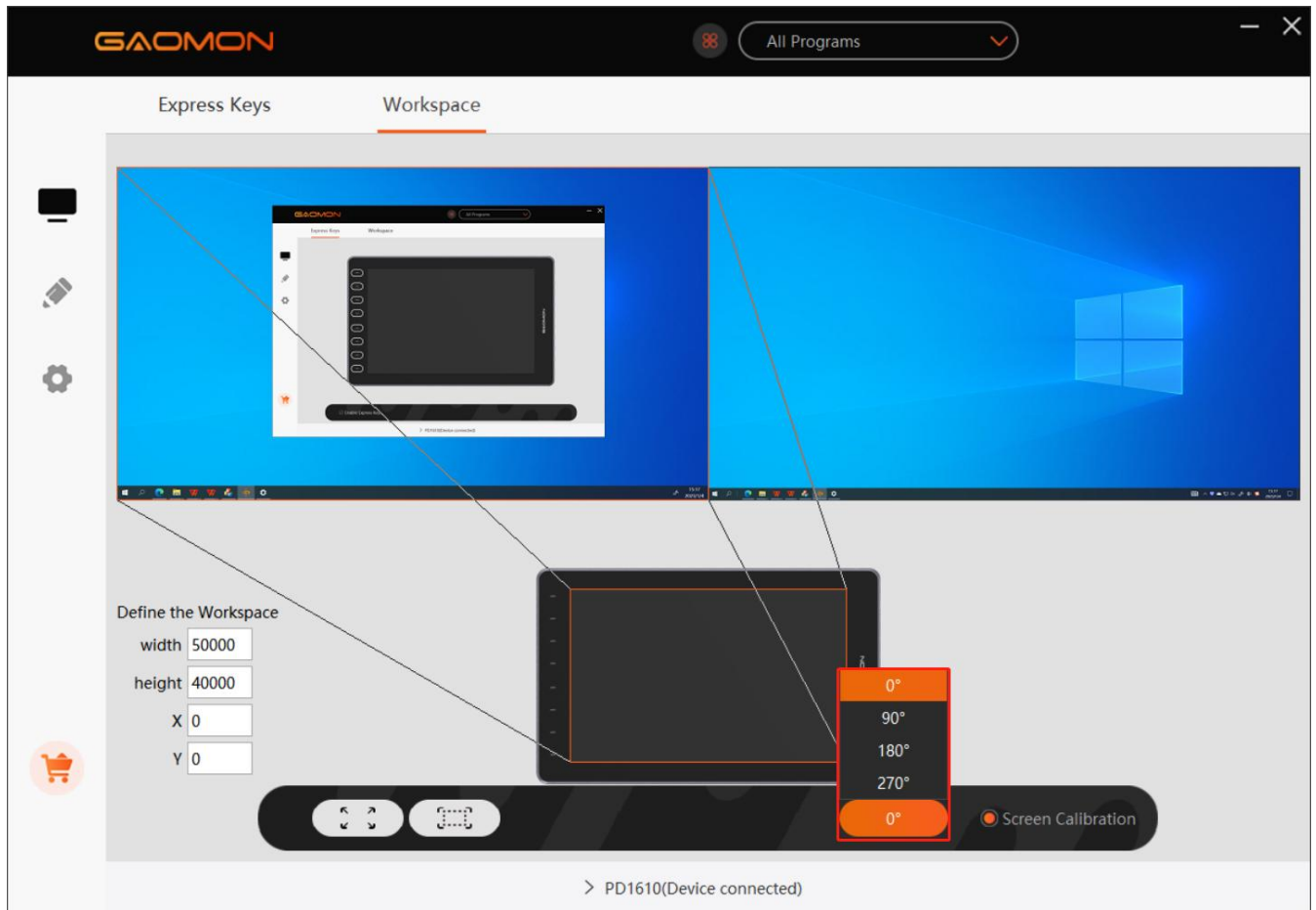

3.3 Pen Buttons Function Setting

Customized Setting Select the function to be achieved on the pop-up dialog box, and it will be saved automatically.

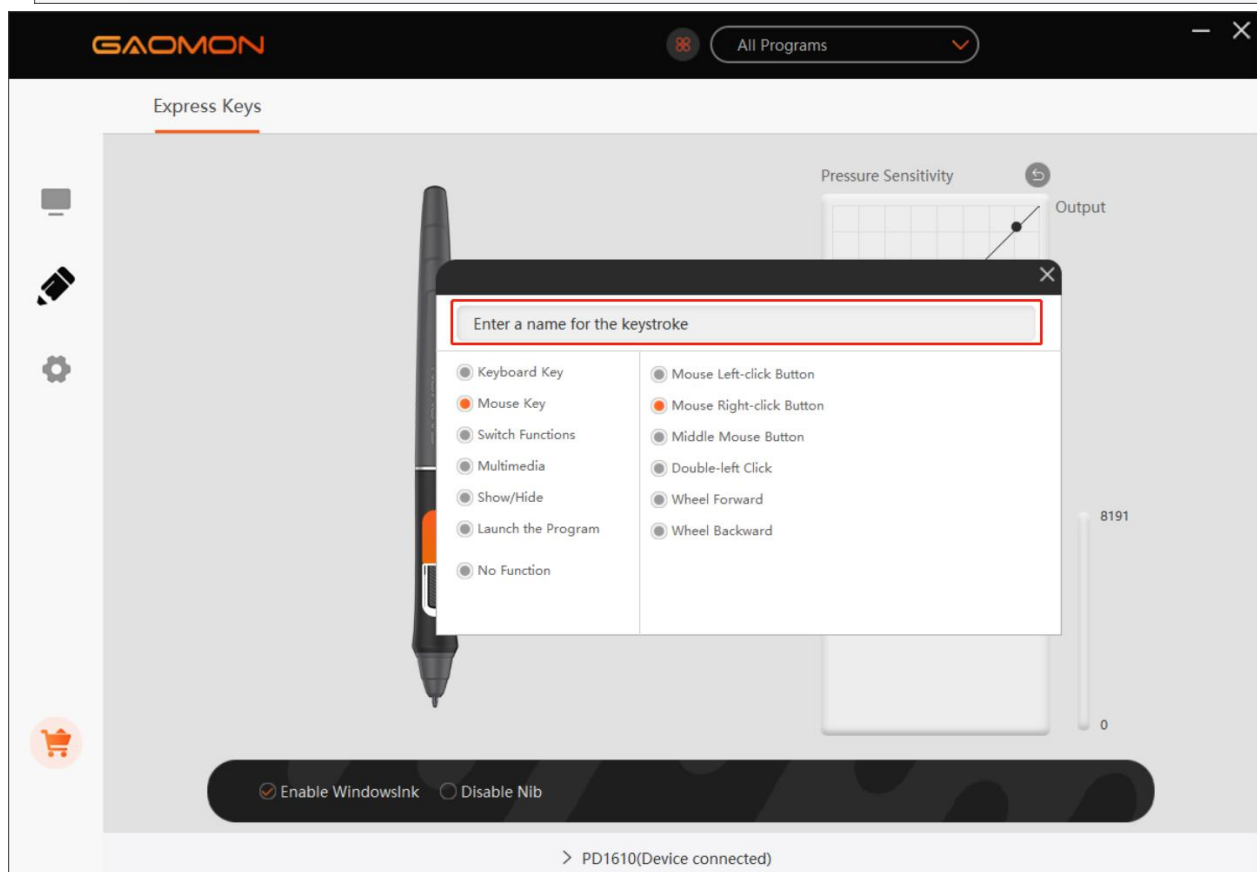
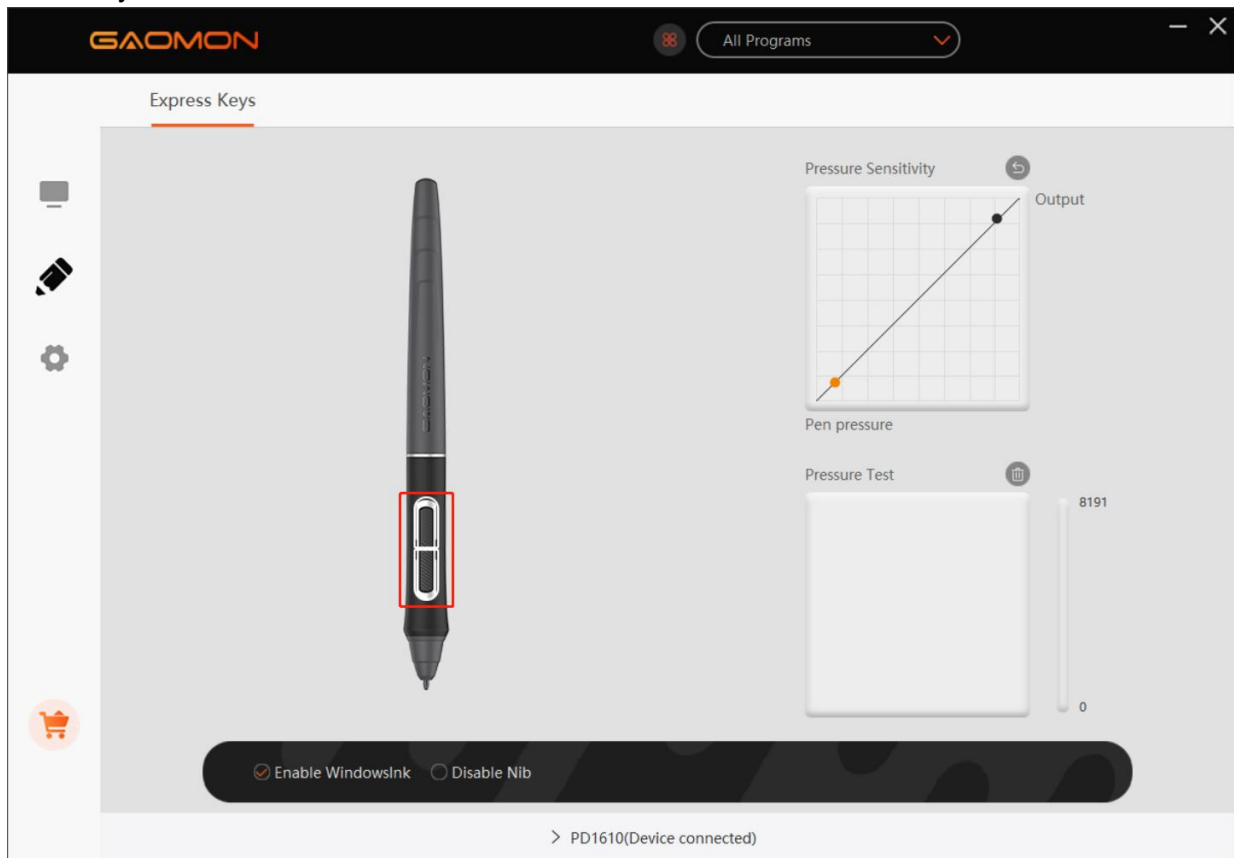

3.4 Pressure Sensitivity Setting

The pressure sensitivity will be changed by dragging the points of the pressure curve.

Drag the points to the upper left for higher sensitivity.

Drag the points to the lower right for lower sensitivity.

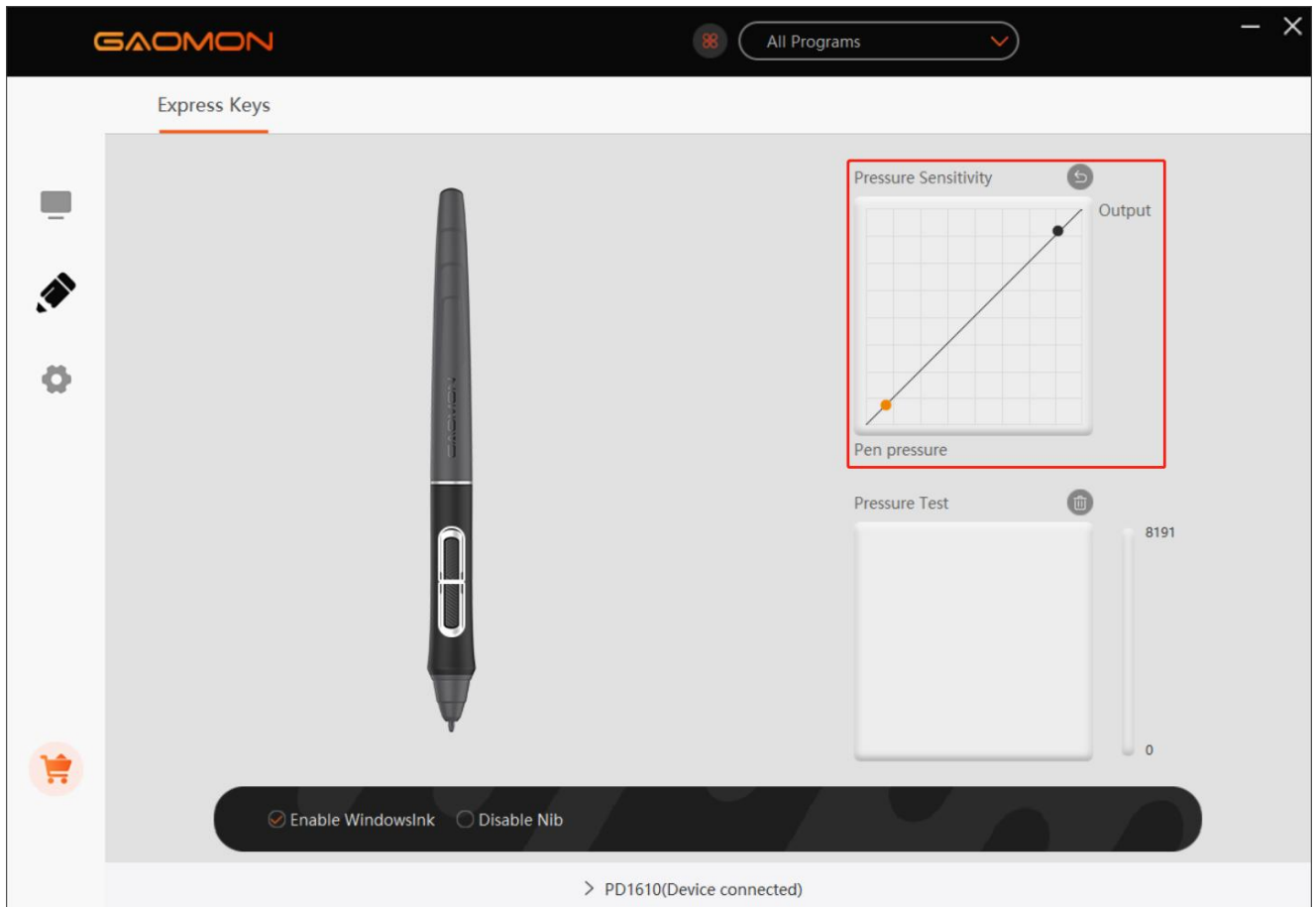

3.5 Pen Pressure Testing

You can gradually apply pressure to the stylus on the screen to test the pressure level.

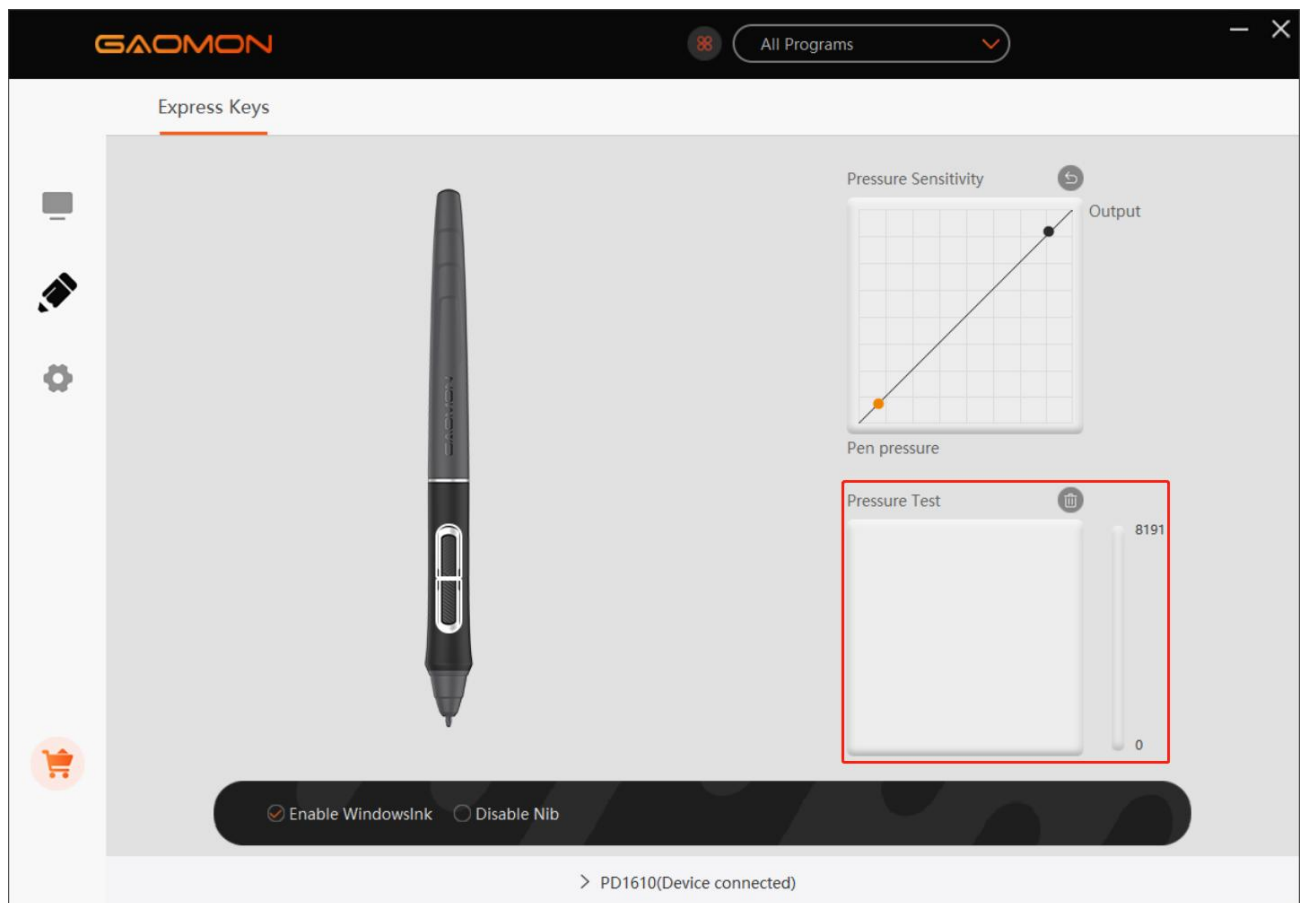

3.6 Calibration

Screen Calibration: Click the red cross on the screen to complete calibration.

Factory Reset: Click 'Factory Reset' to reset the pendisplay.

Cancel Calibration: Click 'Cancel Calibration' or press 'ESC' to stop the calibration.

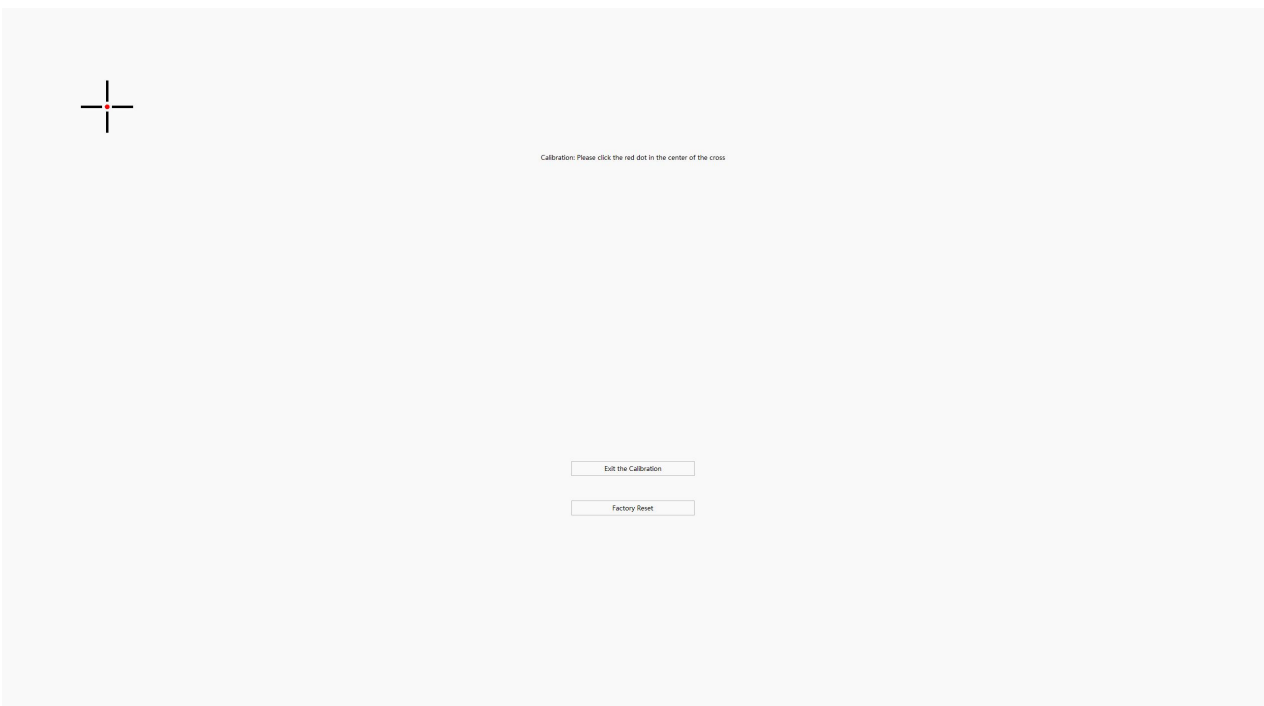
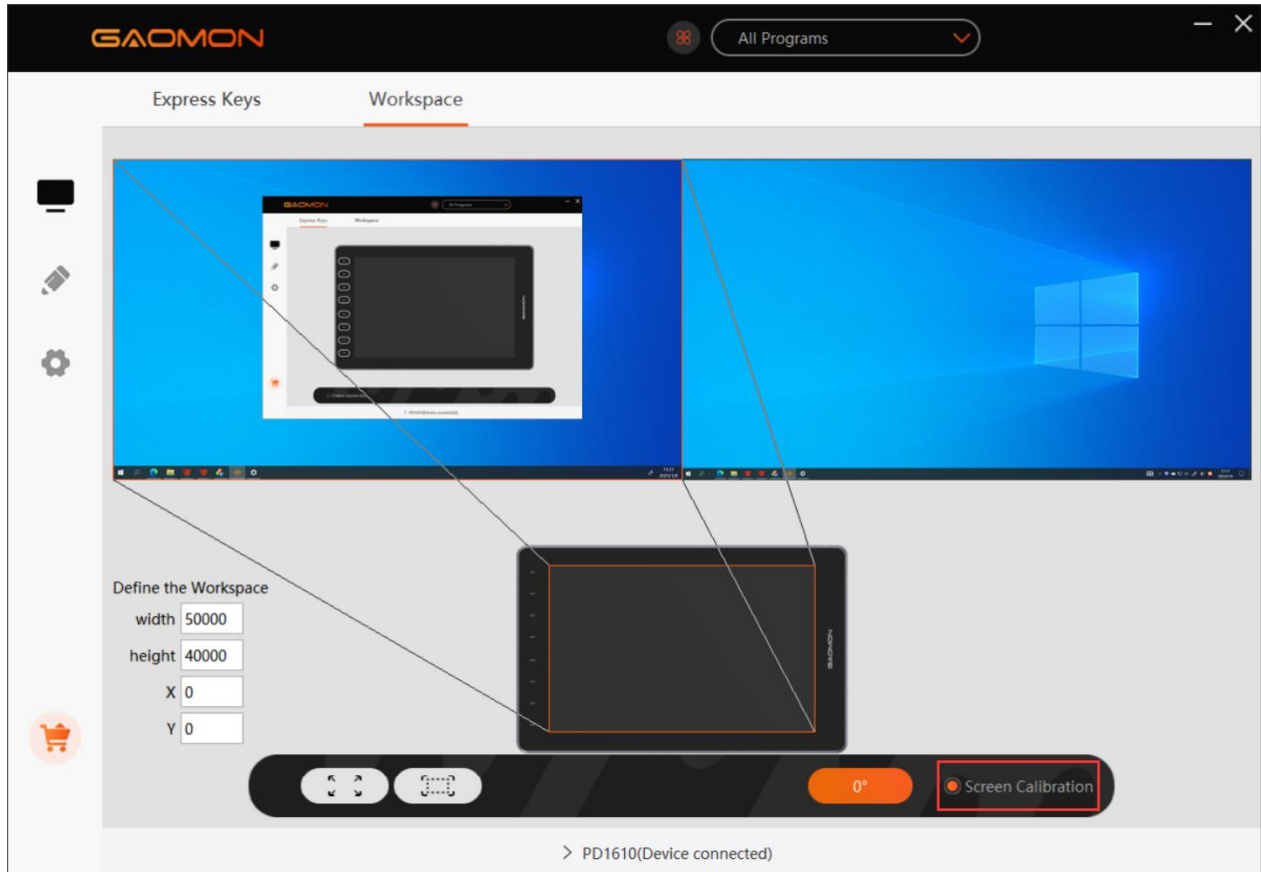

3.7 Enable the Windows Ink Feature

The function is for software that supports Windows Ink, such as Microsoft Office, Windows Journal, Adobe Photoshop CC, SketchBook 6 and so on.

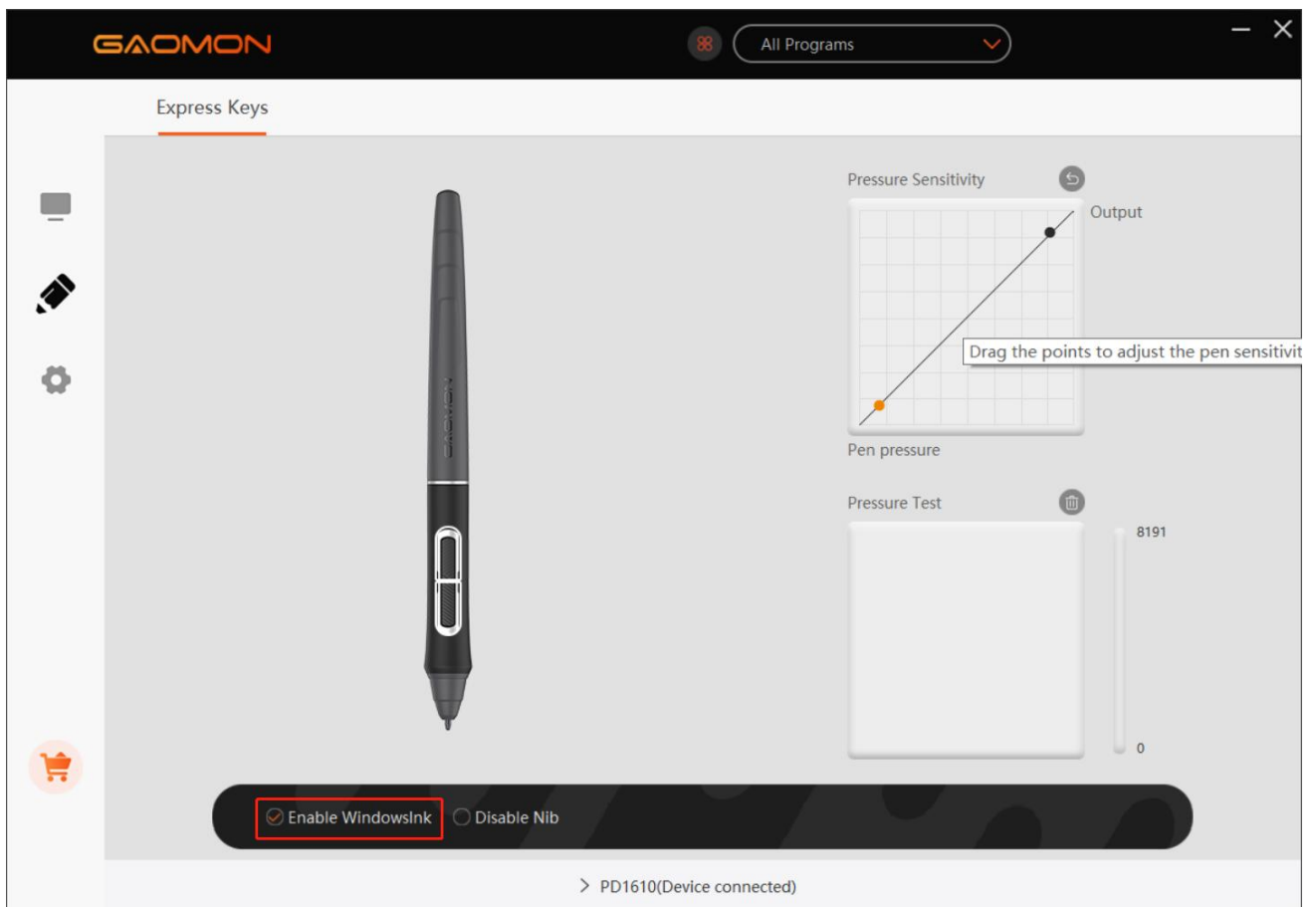

3.8 Customize Press Keys and Pressure Curve

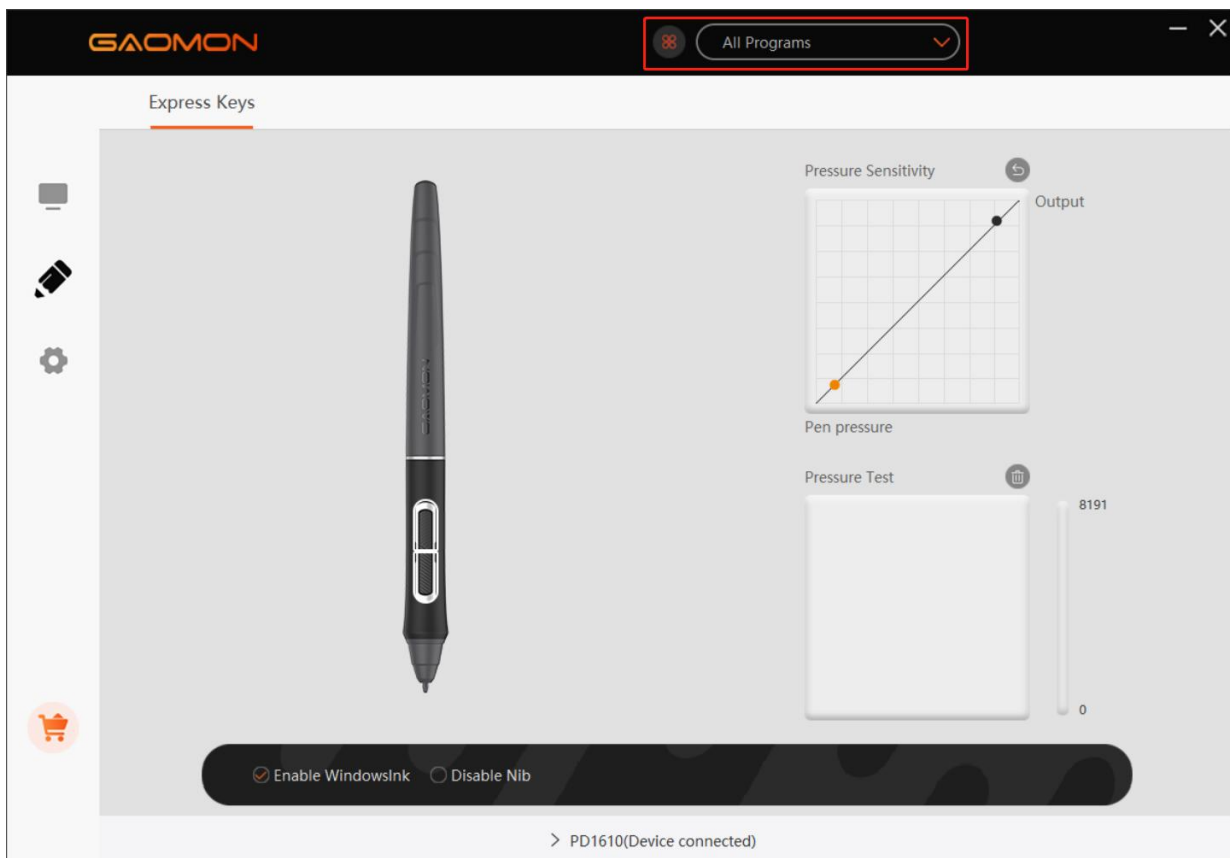

You can customize the function of press keys and pressure curve for different program. Select a program, customize the function of press keys, and adjust the pressure curve, the settings will be automatically saved.

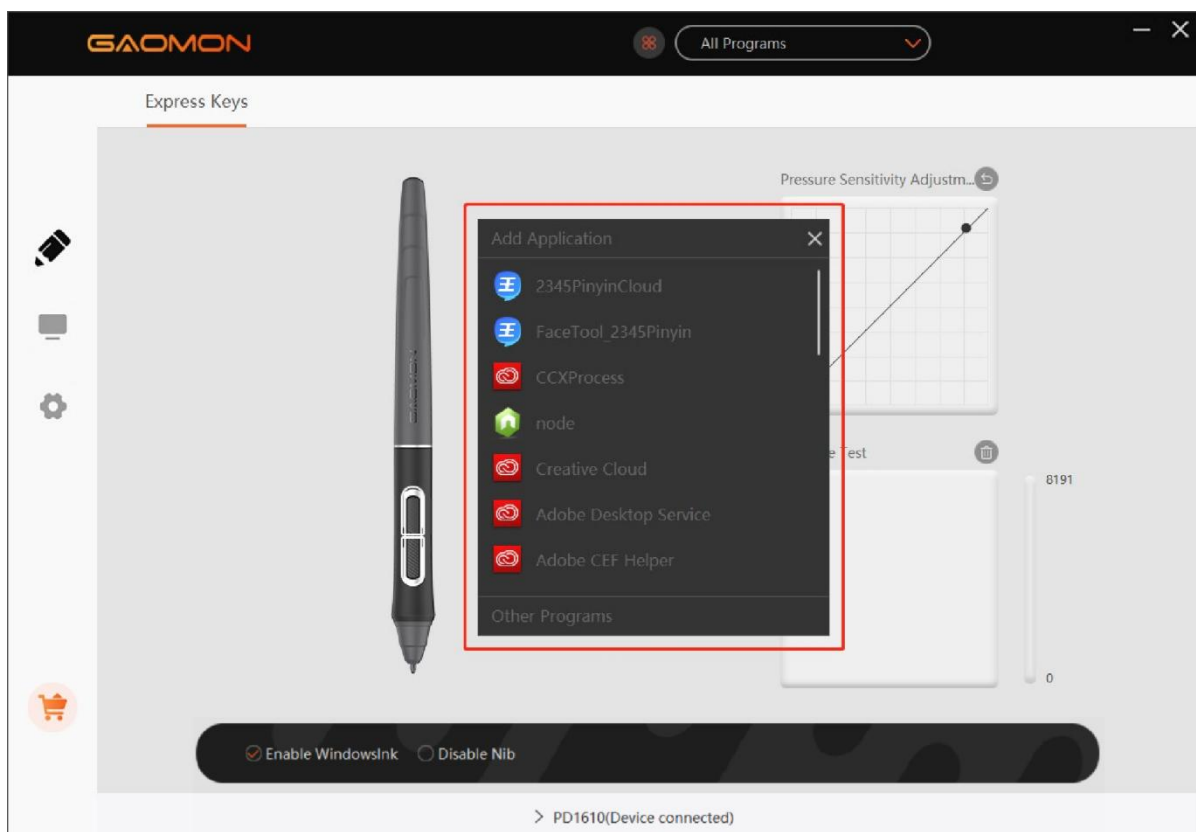

3.9 Data Export and Import

The driver supports exporting and importing your custom configuration data of the product, which is convenient for you to use different software and avoid the trouble of repeated settings.

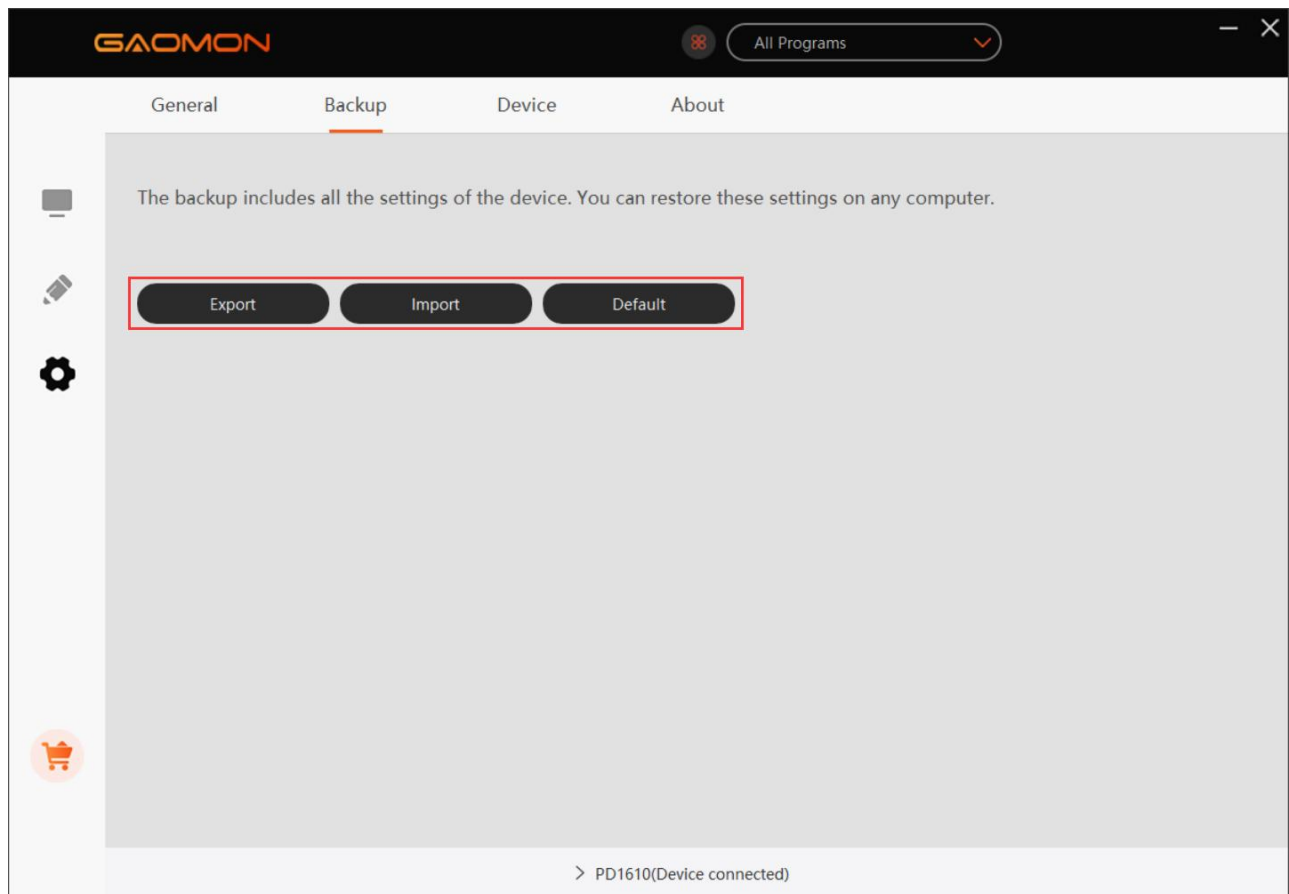

4. Specifications

Model		PD1610
Screen	Panel Size	16inch
	Resolution	2560 x 1600
	LCD Type	IPS
	Active Area	344.8 × 215.5mm
	Contrast Ratio	1000:1
	Brightness	220cd/m ²
	Response Time	26ms
	Viewing Angle	89° /89° (H)/89° /89° (V) (Typ.)(CR > 10)
	Gamut	88% Ntsc
Touch	Touch Technology	Battery-free Electromagnetic Resonance
	Touch Resolution	5080LPI
	Pressure Level	8192Level
	Report Rate	≥ 220PPS
	Sensing Height	10mm
	Accuracy	±0.5mm Center ±3mm (Corner)
Digital Pen	Model	AP517
	Net Weight	13.5g
	Dimension	163.4 x Φ14.5mm
	Side Buttons	Two Customizable Buttons
General	Input Voltage	100-240VAC, 50/60Hz
	Output Voltage	5V 2A
	Video Interface	USB3.1, USB3.1, MiniHDMI
	Dimension	429.8 x 269.8 x 11.5mm
	Net Weight	1.5kg
	OS Support	Windows 7 or later, macOS 10.12 or later, Android(USB3.0 DP1.2)

5. Trouble Shooting

5.1 Breakdowns Related to Display

Malfunctions	Suggested Solutions
Power indicator doesn't work	<ul style="list-style-type: none"> *Make sure the power is on *Make sure the power cable is connected *Check the power socket *Try a new power cable
No display on the screen	<ol style="list-style-type: none"> 1. Make sure the pen display is power on. 2. Make sure the video cable connect correctly. 3. If the pen display is connected to a laptop. Restart the laptop, plug the video cable, and select the Duplicate or Extend mode. 4. Check whether the indicator is green. If not, the pen display and laptop are in sleep mode, press any key or move the mouse to wake them up. 5. Check whether the video cable is bent or damaged. If so, please using a new cable.
Blurry screen	Please change the resolution to 2560 x 1600.
Lack of colors	Check the pins of the signal cable are not bent or fractured.
Chromatic aberration	As the regional color temperature is different, so minor chromatic aberration is a normal phenomenon
Jumping or shaking image	There may be electrical devices around that cause electronic interference.

5.2 Breakdowns Related to Functions

Malfunctions	Suggested Solutions
Digital pen doesn't work and no pressure in the graphics software	<ol style="list-style-type: none"> 1. If the driver is damaged or not properly installed, please uninstall it first and then install it again (please close all graphics software when installing). 2. Please try with a new pen nib. 3. Restart the PC or try another USB port.
Abnormal cursor movement	Reinsert the USB cable or restart the PC.
The side button of the digital pen doesn't work	When pressing the side button, please make sure that the nib didn't touch the tablet surface and the distance between the nib and surface is less than 10mm.
Deviation between the nib and the cursor	Try calibration. (About calibration, please refer to 3.6)

Note:

For more information, please contact us with our email:

service@gaomon.net or [find answer here https://blog.gaomon.net/faq-list/](https://blog.gaomon.net/faq-list/)

6. Contact Us for After-sales Service

GAOMON TECHNOLOGY CORPORATION

 www.facebook.com/Gaomonpentablet

 twitter.com/Gaomonpentablet

 service@gaomon.net

 <https://www.gaomon.net>